





### LEGEND

-  PROPOSED CONTOUR
-  EXISTING CONTOUR
-  RIDGE LINE
-  STORM DRAIN LINE
-  PROPERTY LINE

### PRELIMINARY EARTHWORK

CUT: 170,034 CY  
 FILL: 78,833 CY  
 NET: 91,201 CY (CUT)

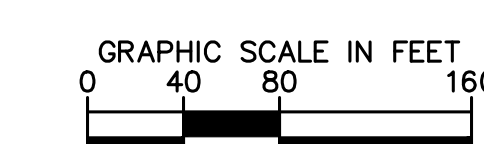
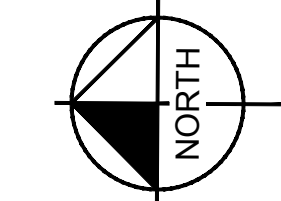
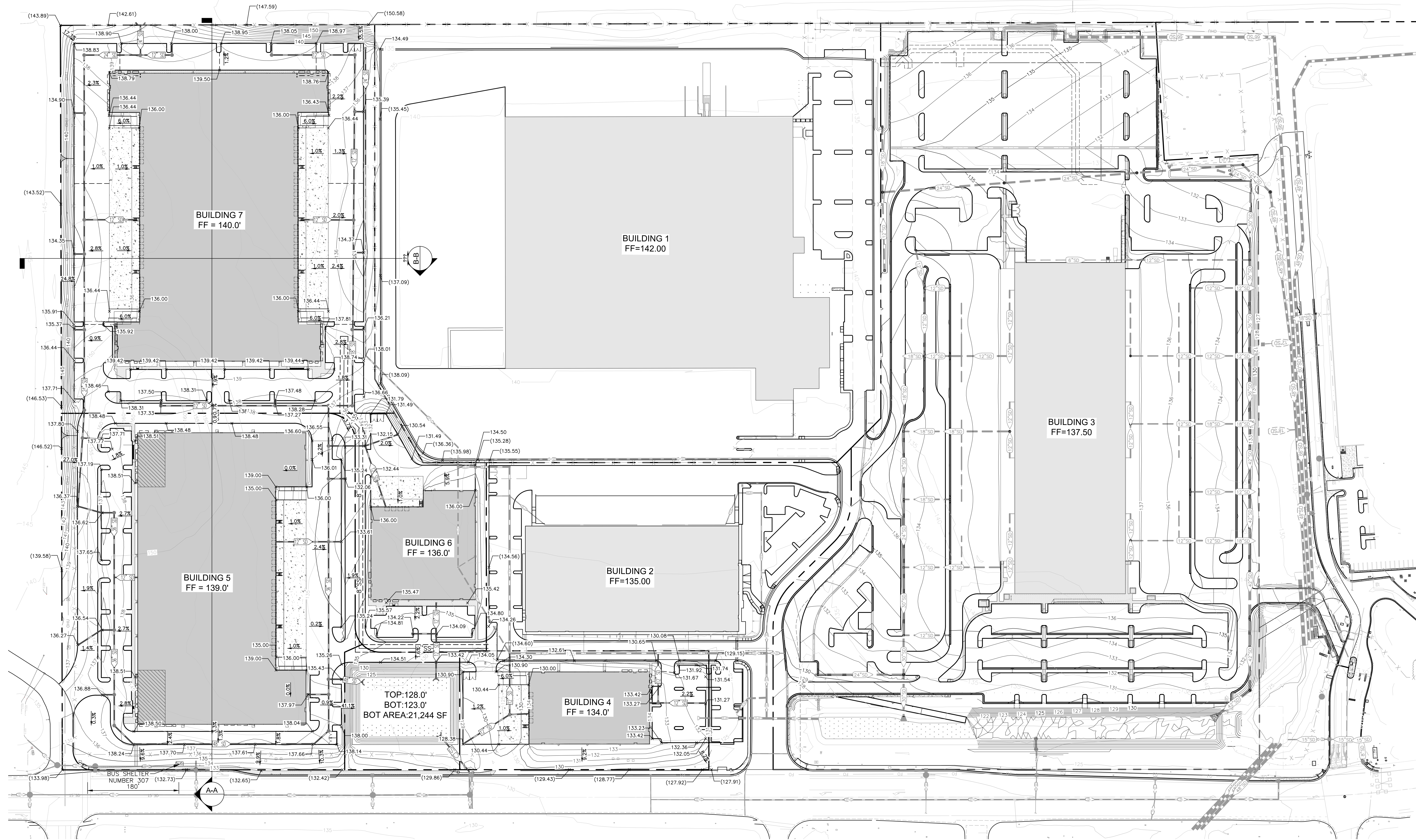

## PRELIMINARY GRADING PLAN

**ROSEVILLE 80 NORTH LOT**  
 7601 FOOTHILLS BLVD.  
 ROSEVILLE, CA 95747

SHEET NUMBER

**ROSEVILLE 80 LAND LLC.**  
 8775 FOLSOM BLVD. #200  
 SACRAMENTO, CA 95826  
 TEL: 916-376-1202

**Kimley-Horn**  
 © 2019 KIMLEY-HORN AND ASSOCIATES, INC.  
 505 CAPITOL AVENUE, SUITE 300  
 SACRAMENTO, CA 95833  
 PHONE: 916-858-5800  
 WWW.KIMLEY-HORN.COM

LICENSED PROFESSIONAL

N/A PROJECT	09/19/2002
DATE	OCT. 2019
SCALE AS SHOWN	
DESIGNED	AP
DRAWN	MRS
CHECKED	SB

REVISIONS

No.

DATE

Plotted By: [Name], Annelis (Whittaker) Sheet: [Name] Layout: [Name] July 13, 2020 08:36:48am K:\SAC\_REV\091913002\_Roseville 80 North Lot\08 CAD\Plan Sheets\North Lot Preliminary\North Lot Preliminary Grading.dwg  
 This document, together with the concepts and designs presented herein, is an instrument of service, and is intended only for the specific purpose and client for which it was prepared. Reuse or improper reliance on this document without written authorization and adaptation by Kimley-Horn and Associates, Inc. shall be without liability to Kimley-Horn and Associates, Inc.

Plotted By: Adams, Brennan; Sheet: Site - Grading; Layout: Layout1; May 18, 2020 12:30:11pm  
 \\kimley-horn\sharepoint.com\SS\Down\Work\0619\CA-SAC\01\Shared Documents\SAC\_LBE\091913002\_Roseville\_80\_North\_Lot\_US\_CADD\Plan\_Sheets\North\_Lot\_Preliminary\_Grading.dwg  
 This document, together with the concept and design presented herein, is an instrument of service, as an instrument of service, is intended only for the specific purpose and client for which it was prepared. Reuse or improper reliance on this document without written authorization and adaptation by Kimley-Horn and Associates, LLC shall be without liability to Kimley-Horn and Associates, LLC.

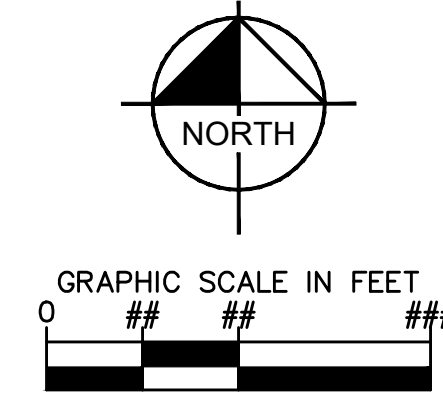
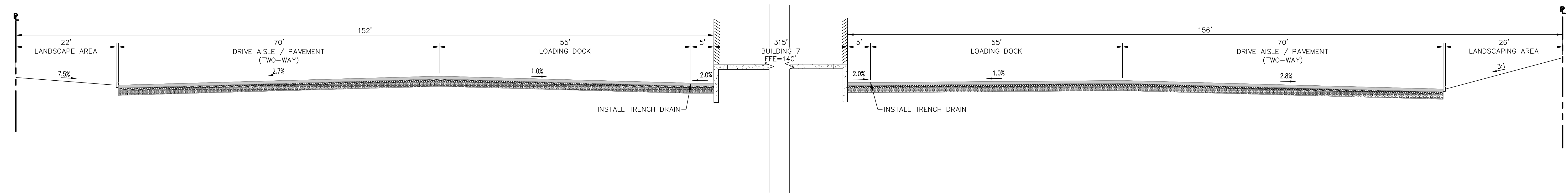
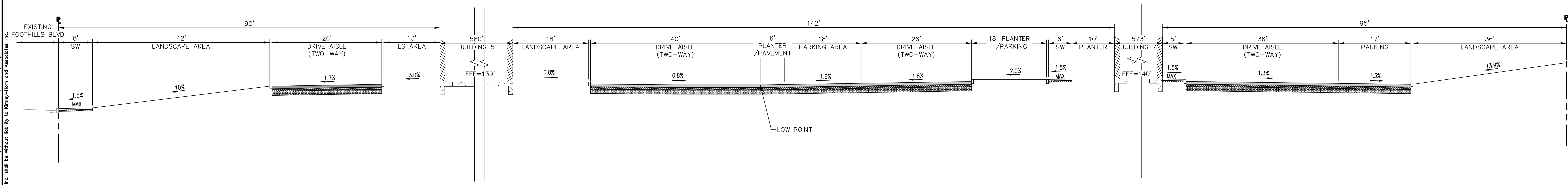

No.	REVISIONS	DATE

ROSEVILLE 80  
LAND LLC.  
8775 FOLSOM BLVD. #200  
SACRAMENTO, CA 95826  
TEL: 916-576-1202

**Kimley-Horn**  
© 2019 KIMLEY-HORN AND ASSOCIATES, INC.  
505 CAPITOL AVENUE, SUITE 300  
ROSEVILLE, CA 95677  
PHONE: 916-854-5900  
WWW.KIMLEY-HORN.COM

LICENSED PROFESSIONAL

N/A PROJECT	DATE	SCALE AS SHOWN	DESIGNED	AP	DRAWN	MISC	CHECKED	SE
097913002	OCT. 2019							

## PRELIMINARY GRADING SECTIONS

ROSEVILLE 80  
NORTH LOT  
7601 FOOOTHILLS BLVD.  
ROSEVILLE, CA 95747

SHEET NUMBER

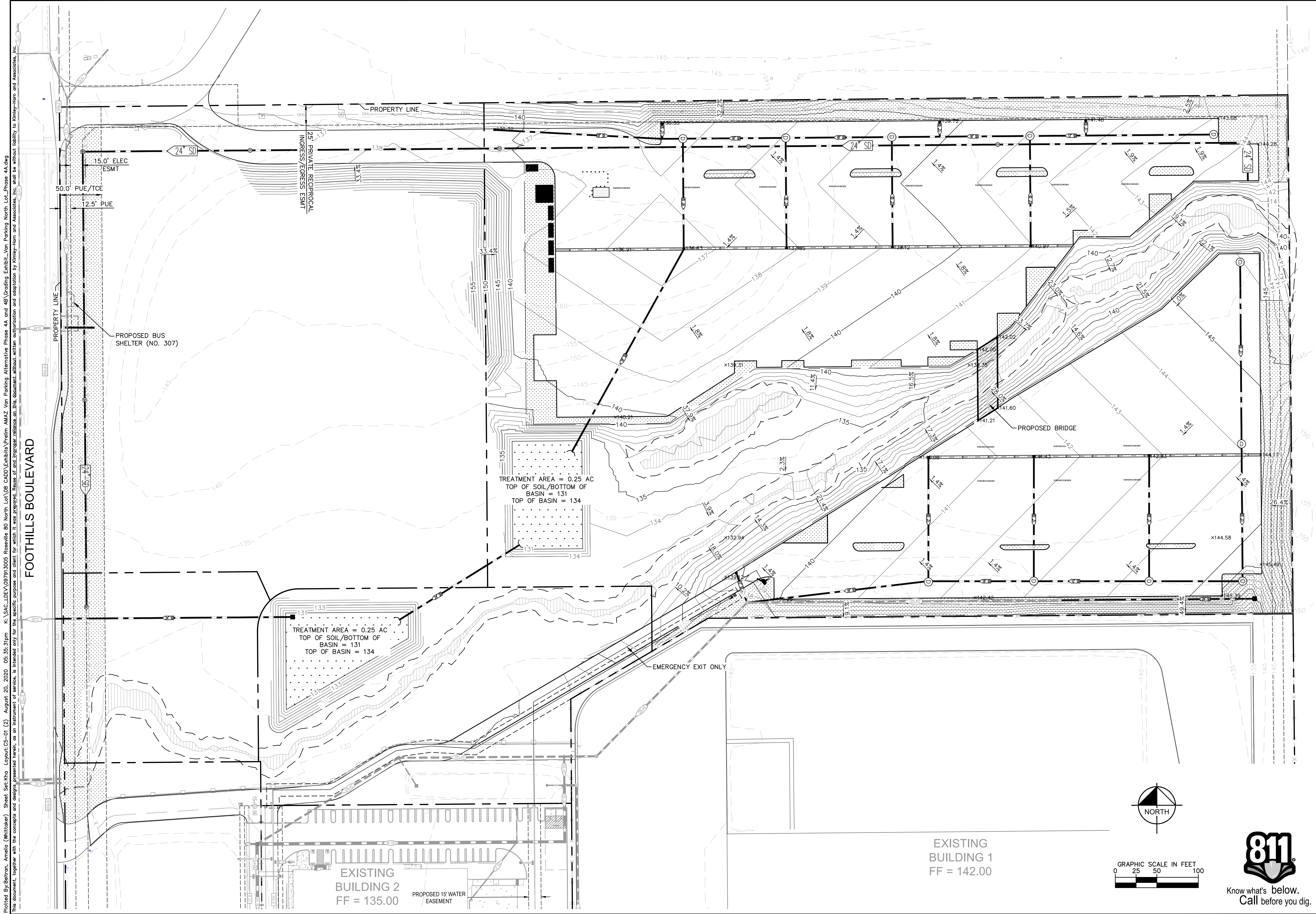

Plotted By: Beltran, Amelia (Whitaker) Sheet Set: K1a Layout: CS-01 (2) August 20, 2020 05:35:33pm K:\SAC\_LDEV\097913005 Roseville 80 North Lot\08 CAD\Exhibits\Freim AMAZ Van Parking Alternative Phase 4A and 4B Grading Exhibit\_Van Parking North Lot\_Phase 4A.dwg  
 This document, together with the concept and design presented herein, as an instrument of service, is intended only for the specific purpose and client for which it was prepared. Reuse of and integration into other documents without written authorization and adaptation by Kimley-Horn and Associates, Inc. shall be without liability to Kimley-Horn and Associates, Inc.

FOOTHILLS BOULEVARD

<b>ROSEVILLE 80 NORTH LOT</b> PREPARED FOR <b>PANATTONI DEVELOPMENT</b> CITY OF ROSEVILLE, CA		<b>VAN PARKING</b> GRADING PLAN - PHASE 4A		LICENSED PROFESSIONAL <b>Kimley-Horn</b> © 2020 KIMLEY-HORN AND ASSOCIATES, INC. 555 CAPITOL MALL, SUITE 300 SACRAMENTO, CA 95814 WWW.KIMLEY-HORN.COM		PANATTONI®	
KHA PROJECT 097913005	DATE AUGUST 2020	SCALE AS SHOWN	DESIGNED AJP	DRAWN AJP	CHECKED SE	DATE	REVISIONS
						No.	DATE
						SHEET NUMBER <b>CP-1</b> of 8	



Know what's below.  
Call before you dig.